

# Mobile Responsive Application

ZINFI's Unified Partner Management (UPM) platform is optimized for smartphones and other mobile devices. This capability offers your field team and partners a significant edge, enhancing revenue potential and improving customer and partner interactions. With Mobile UPM, professionals can instantly access crucial data, update opportunities, schedule tasks, or log calls and emails. Embrace a modern business approach—go mobile with ZINFI UPM and stay at the forefront of action.

## Mobile-First Architecture

With ZINFI's "mobile first and mobile ready" strategy, development and updating of the mobile experience through this powerful app are driven by the requirements of the connected, on-the-go environment that defines channel management today. The ZINFI Mobile Ready platform offers intuitive, user-friendly design and a rich feature set. Currently supported mobile platforms: iOS, Android (check compatible versions). ZINFI UPM's Mobile App platform is a mobile/tablet client with intuitive and user-friendly design and a rich feature set.

ZINFI's mobile app enables your organization and your channel partners to instantly access and manage accounts, leads, opportunities, calendar entries, activities, and many other features on the go. The mobile app comes with push notifications, location services and other functionality designed to make the platform powerful.

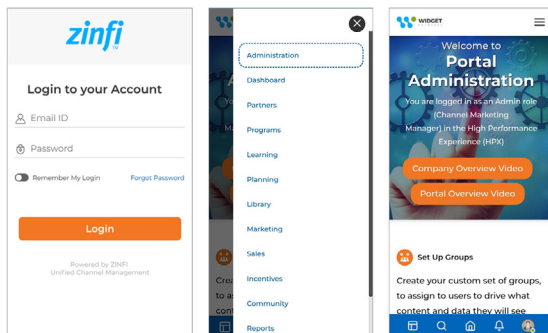

### Key Features Include:

- ✓ App Functionality & Flexibility Management
- ✓ App Screen Experience & Consistency Management
- ✓ User Navigation Management
- ✓ Custom Landing Page and Branded Header Toolbar

## Dynamic App Creation

To create the “native” mobile application of the Unified Partner Management platform, ZINFI reuses up to 80% of its native code base from the web application architecture. ZINFI uses cutting-edge technologies to add dynamic web application capabilities in a simplified and efficient way. The coding is then converted through a powerful framework that “translates” the necessary components into formats for mobile display. The final system layer compiles these components together into a native app that resides and performs on the mobile device, a singular output that is compatible with both Android and iOS.

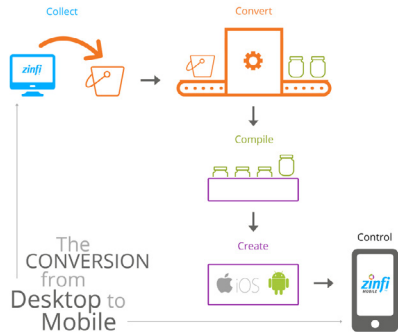

### Key Features Includes:

- ✓ iOS & Android Compatibility
- ✓ Data Synchronization Management
- ✓ Data Accessibility Management

## Extensive Features and Functionalities

ZINFI UPM Mobile App features an intuitive experience with the Reports Module, options to assign Prospects to Country/Language/User/Groups and functionalities to share content and configure visibility on-the-go. Record Assignment Functionality allows Admins and Partner Admins to assign records viz. Prospects, Contacts and Accounts to User/Groups from the Mobile App itself. The Business Intelligence Reports module allowing channel marketing admins and partners to generate extensive reports to measure performance across the channel, is incorporated in the Mobile UPM version. Content Visibility Configuration allows Admins and Partner Admins to control the visibility of the Library Assets/Contents as per the visibility configurators/parameters – Country, Language and User/Groups from the Mobile App itself. Similarly, Content Sharing allows Admins and Partner Admins to share Library Assets/Contents to Users/Partners/Partner Users; all on-the-go.

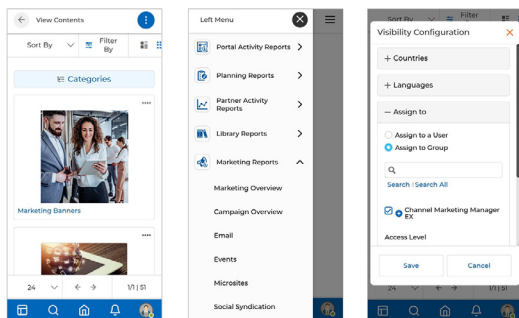

### Key Features Includes:

- ✓ Record Assignment Functionality
- ✓ Mobile Reports
- ✓ Content Visibility Configuration
- ✓ Content Sharing

#### AMERICAS

sales.noram@zinfitech.com  
6200 Stoneridge Mall Road, Suite 300  
Pleasanton, CA 94588  
United States of America

#### EUROPE, MIDDLE EAST AND AFRICA

sales.emea@zinfitech.com  
Davidson House  
Forbury Square, Reading  
RG1 3EU, United Kingdom

#### ASIA PACIFIC

sales.apj@zinfitech.com  
3 Temasek Avenue  
#21-00 Centennial Tower  
Singapore 039190

Please visit [www.zinfo.com/contact-us](http://www.zinfo.com/contact-us) to see the locations and contact information of our other global offices.

© ZINFI Technologies Inc. All Rights Reserved.

Australia • China • Hong Kong • India • Indonesia • Japan • Korea • Romania • Singapore • UK • USA