

Native Applications for Mobile Devices

Extending the ZINFI Unified Channel Management (UCM) platform to smartphones and other mobile devices gives your field team and partners a strong competitive advantage that can help drive revenue and enhance the customer and partner experience. Whether they are viewing up-to-the-minute account or contact information, updating an opportunity, scheduling an activity, or logging a call or email to history, with Mobile UCM your on-the-go professionals will have the secure, instant access to vital information and productivity tools that they need to succeed. Take a new approach to business—go mobile with ZINFI UCM and live where the action is.

Mobile-First Architecture

With ZINFI's "mobile first" strategy, development and updating of the mobile experience through this powerful app are driven by the requirements of the connected, on-the-go environment that defines channel management today. The ZINFI mobile platform offers intuitive, user-friendly design and a rich feature set.

ZINFI's mobile app enables your organization and your channel partners to instantly access and manage accounts, leads, opportunities, calendar entries, activities and many other features on the go. The mobile app comes with push notifications, location services and other functionality designed to make the platform more intelligent and powerful.



Key Features Include:

- ✓ App Functionality & Flexibility Management
- ✓ App Screen Experience & Consistency Management
- ✓ User Navigation Management
- ✓ Process/Flow Execution Speed Management

Dynamic App Creation

To create the “native” mobile application of the Unified Channel Management platform, ZINFI reuses up to 80% of its native code base from the web application architecture. ZINFI uses cutting-edge technologies to add dynamic web application capabilities in a simplified and efficient way. The coding is then converted through a powerful framework that “translates” the necessary components into formats for mobile display. The final system layer compiles these components together into a native app that resides and performs on the mobile device, a singular output that is compatible with both Android and iOS.

This web application and conversion architecture means the mobile app is ultimately more responsive and easy to use. The app is compatible with iOS and Android frameworks from the get-go. The ZINFI mobile app allows your users to access lead information and history quickly, and efficiently perform a variety of core activities like sending emails, updating opportunities, scheduling events, adding tasks and more.

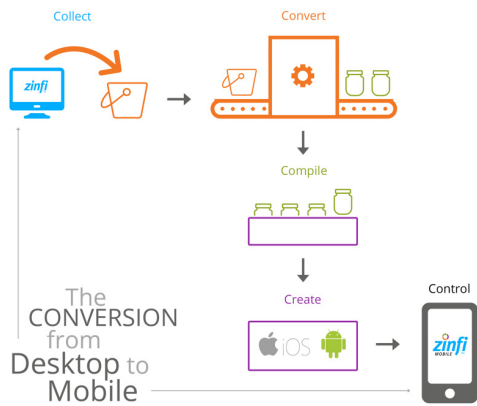

Key Features Includes:

- ✓ iOS & Android Compatibility
- ✓ Data Synchronization Management
- ✓ Data Accessibility Management

AMERICAS

sales.noram@zinfitech.com
 6200 Stoneridge Mall Road, Suite 300
 Pleasanton, CA 94588
 United States of America

EUROPE, MIDDLE EAST AND AFRICA

sales.emea@zinfitech.com
 Davidson House
 Forbury Square, Reading
 RG1 3EU, United Kingdom

ASIA PACIFIC

sales.apj@zinfitech.com
 3 Temasek Avenue
 #21-00 Centennial Tower
 Singapore 039190

Please visit www.zinfo.com/contact-us to see the locations and contact information of our other global offices.

© 2019 ZINFI Technologies Inc. All Rights Reserved.

Australia • China • Hong Kong • India • Indonesia • Japan • Korea • Romania • Singapore • UK • USA